



ORTHODONTIC
TUBES



ORTHODONTIC TUBES AND MINI TUBES

ICERAM[®]

Mini Tube

ORTHOMETRIC AESTHETIC MINI TUBE

Iceram Mini Tube are indicated as auxiliary accessories to be used for correction of several dental and skeletal malocclusions.

They are made of transparent polycrystalline ceramic, also known as Poly Sapphire, using an extremely efficient process, CIM – Ceramic Injection Molding, which guarantees good aesthetics, resistance, and durability

Due to their small size, anatomical design and rounded edges, they offer much more comfort to the patient and expand the possibilities of applications for the orthodontist.

The mini tubes allow bonding in situations of decreased access, such as in cases of partially erupted second molars, where only the mesiovestibular cusp is visible.

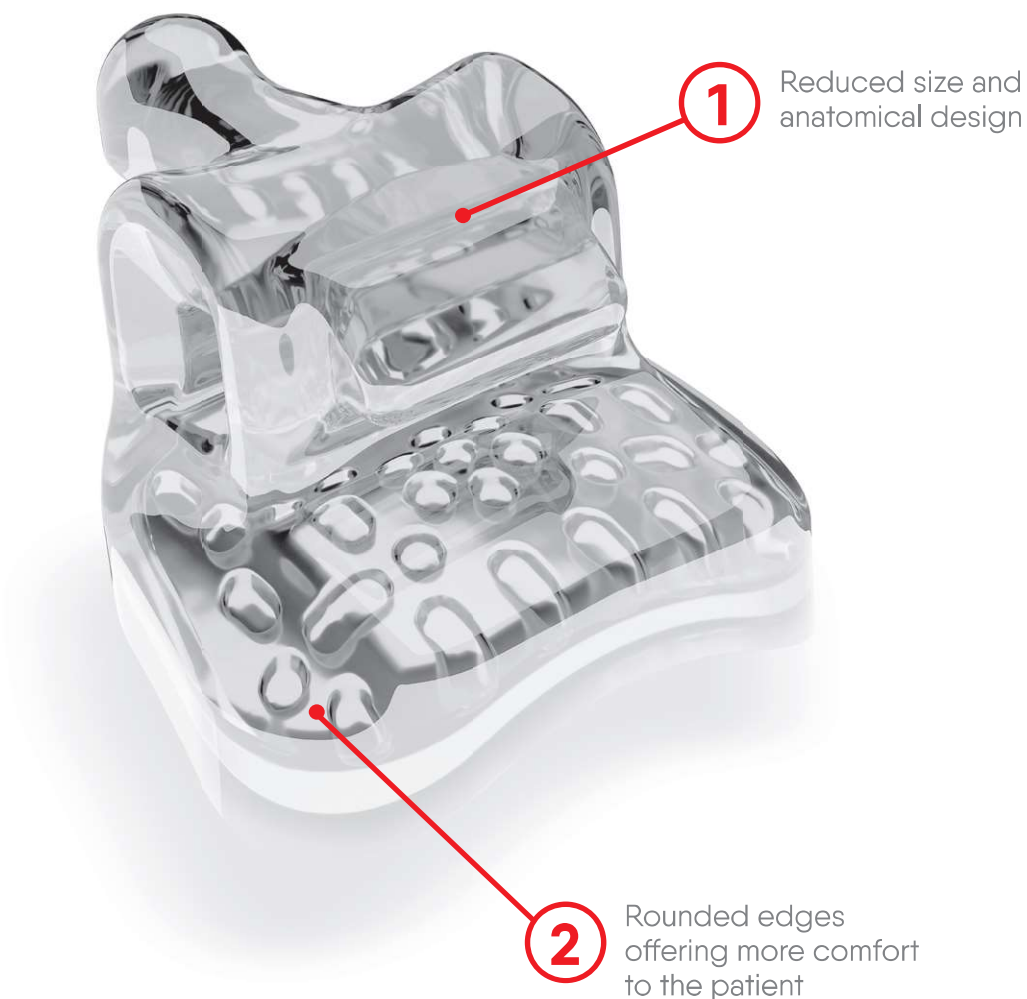

The ceramic mini tubes were developed for use in upper and lower premolars, contributing to the correction of gyroversions, being associated with other orthodontic accessories or with aligners.

Their base has mechanical retention made with pins and enhanced with the exclusive and patented laser texturing, **LB2 – Laser Bond Booster**, which gives up to 30% higher retention when compared to traditional blasting.

Universal design, allowing for use on both the upper and lower arches.

Anatomical curvature of the base, with double curvature of mesiodistal and cervico-occlusal radius at the bonding base.

Slot with tapered entry for easy insertion of the archwire.

Gingival off-set of the base, with a displacement that allows for more cervical-facing bonding, reducing the incidence of occlusal interference.

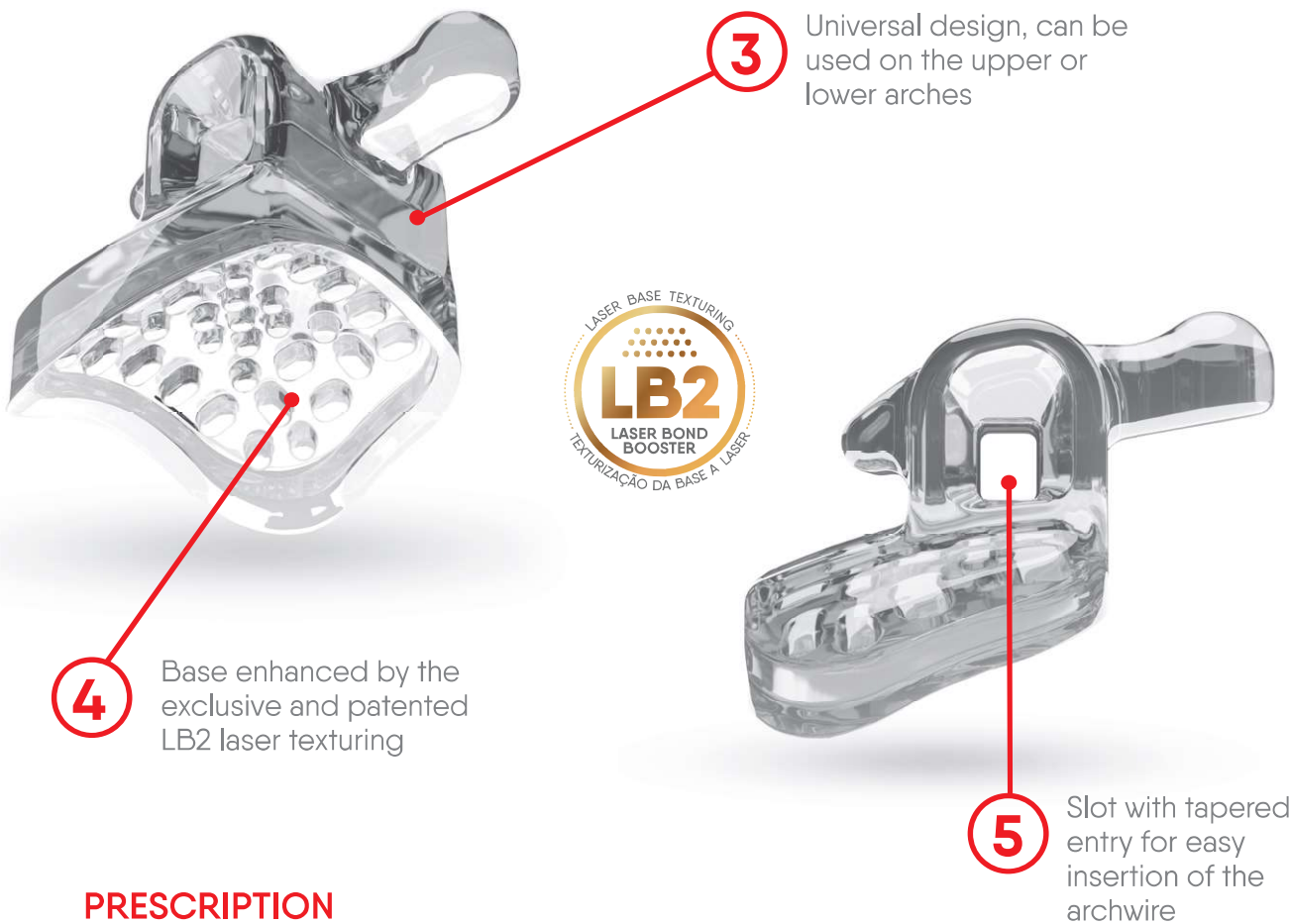

PRESCRIPTION



Pack with 2 units
21.02.2002

UNIVERSAL 0.022" ICERAM AESTHETIC MINI TUBE							BONDING	
PRESCRIPTION	USE	LEN.	TUBE	TORQUE	DISTAL	QTY.	0.022x0.028"	
Upper	UNIVERSAL	5 4	3.0 mm	-	-7°	0°	2	21.02.2002
	UNIVERSAL	4 5	3.0 mm	-	-7°	0°	2	21.02.2002
Lower	UNIVERSAL	5 4	3.0 mm	-	-7°	0°	2	21.02.2002
	UNIVERSAL	4 5	3.0 mm	-	-7°	0°	2	21.02.2002